

Section Two

Audio/Video Cable Connections

B Connecting to a Stereo VCR

Connection & Installation

Connect the Nintendo 64 to either your TV or VCR using the Stereo Audio/Video Cable. Choose one of the connection methods on pages 4-6 that matches the connections for your TV or VCR; **you will only need to make one kind of connection.**

- **If your TV or VCR does not have audio/video connections** (i.e., the illustrations on pages 4-6 do not match your TV or VCR), then turn to page 7 for other types of connection methods. You will need to use a Nintendo 64 RF Switch and RF Modulator (sold separately).
- If you currently have a Super Nintendo Entertainment System® connected to your TV or VCR and want to connect both the Super NES® and Nintendo 64 Control Decks, then turn to page 8.

Audio/Video Cable Connections

A Connecting to a Stereo TV

Make sure to plug the Audio/Video Cable into the "INPUT" connections of your TV (Do not use connections labeled "OUTPUT").

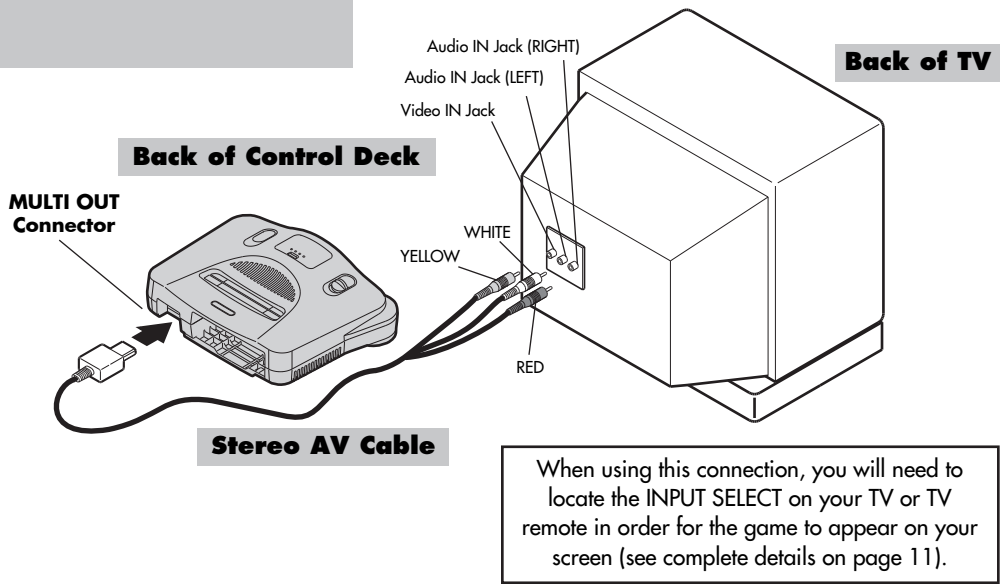

4

After completing the connections as shown, turn to pg 9.

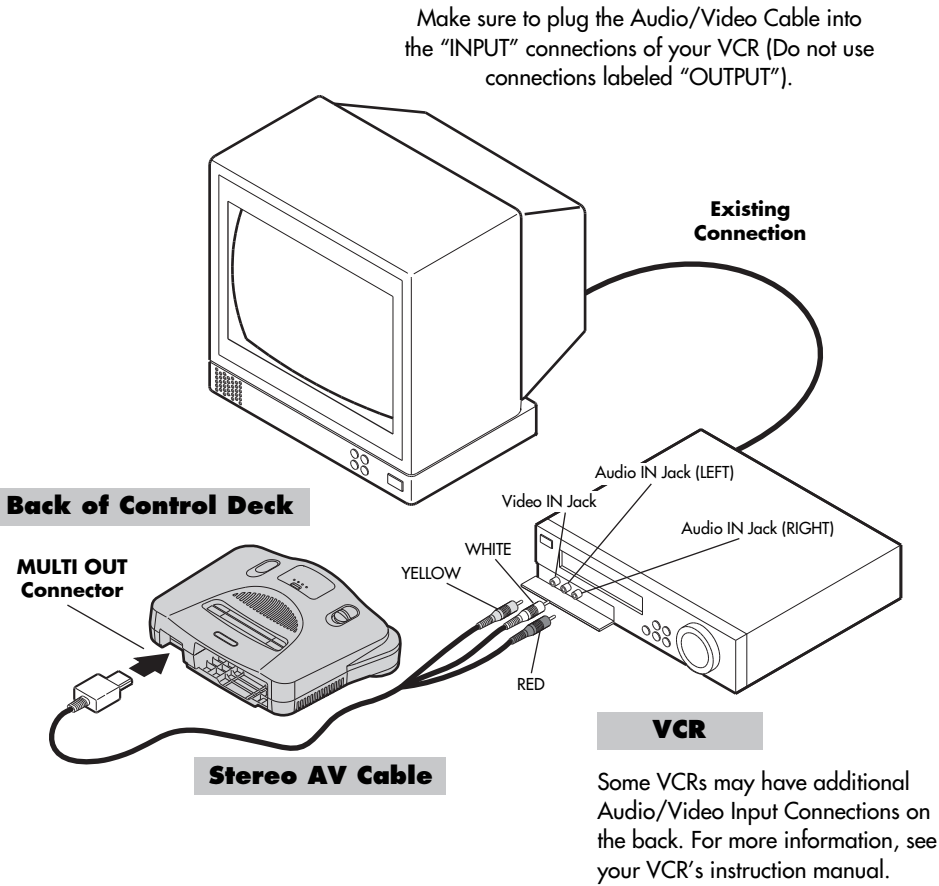

After completing the connections as shown, turn to pg 9.

5